



# McGuire Manufacturing Co., Inc.

60 Grandview Court  
Cheshire, Connecticut 06410  
(203) 699-1801 Fax (203) 699-1813  
customerservice@mcguiremfg.com mcguiremfg.com

## PRODUCT SPECIFICATION

### Part No.

**SE038, SE050,  
SE058, SE125,  
SE150, SE172D**

**Job Name:**

**Submittal Number:**

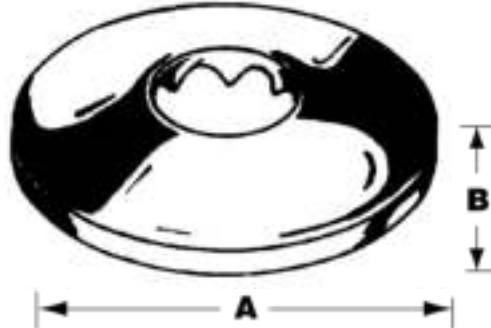

NO.	SIZE	A	B
SE038	3/8" IPS	2-1/2"	1/4"
SE050	1/2" IPS	2-1/2"	1/4"
SE058	5/8" OD (1/2" Copper)	2-1/2"	1/4"
SE125	1-1/4" OD	2-3/4"	1/2"
SE150	1-1/2" OD	2-3/4"	1/2"
SE172D	1-22/32" OD	3"	1-1/2"

### Specifications:

All wrought steel shallow flanges for use with P-Traps, supply kits and shower arms. Highly polished chrome plated.



#### WARNING:

This product can expose you to chemicals including lead, which is known to the State of California to cause cancer, and birth defects or other reproductive harm. For more information go to [www.P65Warnings.ca.gov](http://www.P65Warnings.ca.gov).



# McGuire Manufacturing Co., Inc.

60 Grandview Court  
 Cheshire, Connecticut 06410  
 (203) 699-1801 Fax (203) 699-1813  
 customerservice@mcguiremfg.com mcguiremfg.com

## PRODUCT SPECIFICATION

### Part No.

## All Cast Brass Nipples and Set Screw Flanges

**Job Name:**

**Submittal Number:**



NO.	SIZE
1127	1-1/4" x 6"
2127	1-1/2" x 6"
3127	2" x 6"

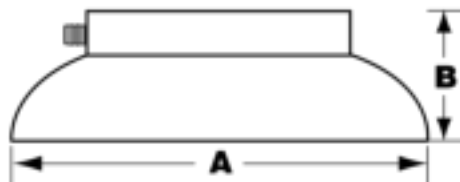

NO.	SIZE	A	B
127038	3/8" I.P.S.	2.39"	.73"
127050	1/2" I.P.S.	2.25"	.7"
127058	5/8" O.D. (1/2" Copper)	2.39"	.73"
127069	11/16" O.D.	2.39"	.73"
127075	3/4" I.P.S.	2.25"	.7"
127078	7/8" O.D. (3/4" Copper)	2.25"	.7"
127100	1" I.P.S.	2.75"	.9"
1271251	1-1/4" I.P.S.	2.765"	.95"
1271250	1-1/4" O.D.	2.95"	1"
1271501	1-1/2" I.P.S.	2.95"	.9"
1271500	1-1/2" O.D.	2.95"	1"
1271580	1-5/8" O.D. (1-1/2" Copper)	2.8"	.9"
1271720	1-23/32" O.D.	Discontinued	
1272001	2" I.P.S.	3.675"	.9"
1272000	2" O.D.	3.3"	.95"



NO.	SIZE
N038015	3/8" x 1-1/2"
N038020	3/8" x 2"
N038030	3/8" x 3"
N038035	3/8" x 3-1/2"
N038040	3/8" x 4"
N038045	3/8" x 4-1/2"
N038050	3/8" x 5"
N038055	3/8" x 5-1/2"
N038060	3/8" x 6"
N038065	3/8" x 6-1/2"
N038100	3/8" x 10"
N038120	3/8" x 12"
N038150	3/8" x 15"
N038200	3/8" x 20"
N038240	3/8" x 24"
N050030	1/2" x 3"
N050040	1/2" x 4"
N050050	1/2" x 5"
N050055	1/2" x 5-1/2"
N050060	1/2" x 6"
N050080	1/2" x 8"
N125060	1-1/4" x 6"
N150060	1-1/2" x 6"
N200060	2" x 6"

### Specifications:

All Cast Brass Nipples and Set Screw Flanges for use with P-Traps, supplies and shower arms. Highly polished and heavy chrome plated.



#### WARNING:

This product can expose you to chemicals including lead, which is known to the State of California to cause cancer, and birth defects or other reproductive harm. For more information go to [www.P65Warnings.ca.gov](http://www.P65Warnings.ca.gov).



**McGuire Manufacturing Co., Inc.**

60 Grandview Court

Cheshire, Connecticut 06410

(203) 699-1801 Fax (203) 699-1813

customerservice@mcguiremfg.com mcguiremfg.com

**PRODUCT SPECIFICATION**

**Part No.**

**WE125BS, WE150BS**

**Wrought Brass  
Box Flange**

**Job Name:**

**Submittal Number:**

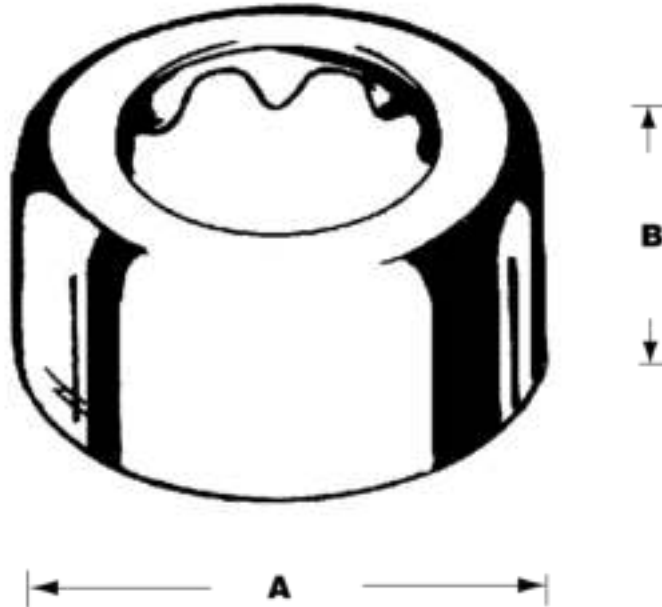

<b>NO.</b>	<b>SIZE</b>	<b>A</b>	<b>B</b>
WE125BS	1-1/4" OD	3"	1-3/4"
WE150BS	1-1/2" OD	3"	1-3/4"

**Specifications:**

Chrome plated wrought brass box flange. Inlet shall be (1 1/4 or 1 1/2) inch OD. Flange shall be McGuire \_\_\_\_\_.



**WARNING:**

This product can expose you to chemicals including lead, which is known to the State of California to cause cancer, and birth defects or other reproductive harm. For more information go to [www.P65Warnings.ca.gov](http://www.P65Warnings.ca.gov).



**McGuire Manufacturing Co., Inc.**

60 Grandview Court  
 P.O. Box 746 • Cheshire, CT 06410  
 203-699-1801 • Fax: 203-699-1813  
 www.mcguiremfg.com

**PRODUCT SPECIFICATION**

**Part No.**

**WE038, WE050,  
 WE058, WE1500,  
 WE13750**

**Job Name:**

**Submittal Number:**

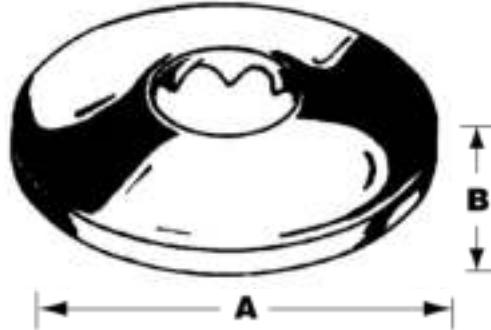

<b>NO.</b>	<b>SIZE</b>	<b>A</b>	<b>B</b>
WE038	3/8" IPS	2-1/2"	1/4"
WE050	1/2" IPS	2-1/2"	1/4"
WE058	5/8" OD (1/2" Copper)	2-1/2"	1/4"
WE1500	1-1/2" OD	2-3/4"	1/2"
WE13750	1-3/8" OD	2-3/4"	1/2"

**Specifications:**

All wrought brass shallow flanges for use with P-Traps, supply kits and shower arms. Highly polished chrome plated.



**WARNING:**

This product can expose you to chemicals including lead, which is known to the State of California to cause cancer, and birth defects or other reproductive harm. For more information go to [www.P66Warnings.ca.gov](http://www.P66Warnings.ca.gov).