

Assembly Instruction

Assembly Instruction

MODEL:Allegro Table Base (006-2/006-1)

Thank you for purchasing this quality product. Be sure to check all packing material carefully for small parts, which may have come loose inside the carton during shipment. Identify and count all parts and compare with the Parts List Below.

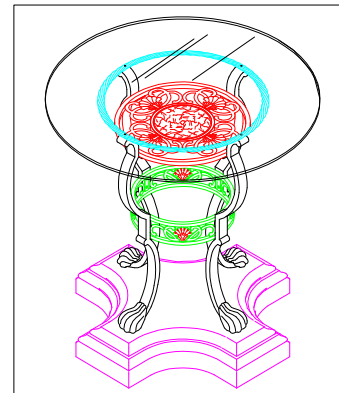
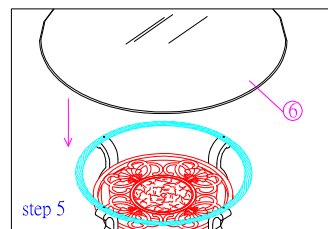
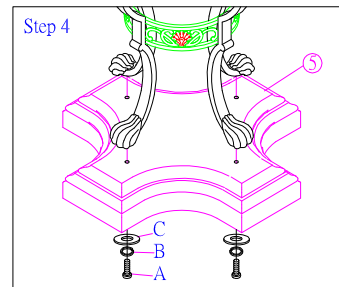
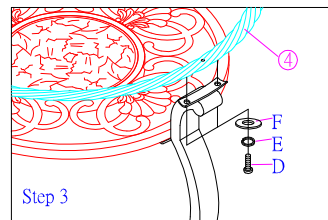
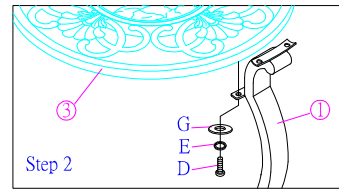
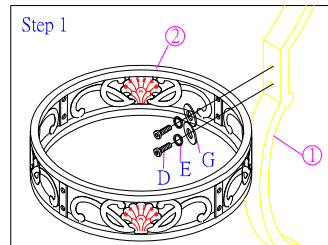

Do not tighten the Bolts until instructed to.

1. Unpack and Identify all parts.
2. Attach the legs (1) to the side of the Bottom Ring (2) (step 1) using flat washer (G), lock washer (E) and 1/4" Allen bolt (D).
3. Attach the Middle Ring (3) to the Legs (1) (step 2) using Flat washer (G), lock washer (E) and 1/4" Allen Bolt (D).
4. Attach the legs (1) to the Top Ring (4) (step 3) using the camber washer (F), lock washer (E), and 1/4" Allen Bolts (D).
5. Lay the table base upside down and attach the Wood Base (5) to the legs using Flat washer (C), Lock washer (B), and 5/16" Allen Bolt (A). (step 4)
6. Tighten all the bolts and set the table base upright.
7. Position the table base in the area it is to be placed before putting on the glass top.
8. Carefully unpack the glass top (6). Clean the bottom side of the glass before placing it on the table base. Place the glass on the base and center.

Never Move the Table Base with the Glass in place.
Make sure to routinely check and retighten all bolts.

NO	PART LIST	Q'TY
1	LEG	4
2	BOTTOM RING	1
3	MIDDLE RING	1
4	TOP RING	1
5	WOOD BASE	1
6	GLASS TOP	1

HARDWARE LIST:

NO	DRAWING	Q'TY	DESCRIPTION
A		4	5/16" * 3-1/8" ALLEN BOLT
B		4	5/16" LOCK WASHER
C		4	5/16" FLAT WASHER
D		24	1/4" * 5/8" ALLEN BOLT
E		24	1/4" LOCK WASHER
F		8	1/4" CAMBER WASHER
G		16	1/4" FLAT WASHER
H		1	5mm ALLEN WRENCH
I		1	4mm ALLEN WRENCH

MADE IN CHINA