

ELBOW BALL CHECK VALVES

Additional options

Type of check valve	Characteristics	Application examples
Version with floating ball (F)	The valve in F version is equipped with a ball, so-called „floating“ ball, with a specific weight of approx 49.9 lb/ft ³ .	Backwater protection (valve is fully opened with the velocity of 0.66 fps).
Version with quasi ball (Q)	The valve in Q version is equipped with a quasi floating ball with a specific weight of approx 63.7 lb/ft ³ .	Lift stations, lift stations with separation of solids, pumps with inverter.
Version with drainage (D)	The valve in D version is equipped with drain plug for valve drainage.	Pumps, dry lift stations, gravity installations with anti reflux valves.

Table of options

Type	DN	Size	Cast Iron	Ductile Iron	Floating Ball (F)	Quasi Ball (Q)	Drainage (D)
Type ESK 01 - threaded							
ESK 01	32	1 1/4"	regular	n/a	option	n/a	n/a
ESK 01	40	1 1/2"	regular	n/a	option	n/a	n/a
ESK 01	50	2"	regular	n/a	option	n/a	n/a
Type ESK 11 - flanged							
ESK 11	50	2"	regular	n/a	option	n/a	n/a
ESK 11	80	3"	n/a	regular	option	option	n/a
ESK 11	100	4"	n/a	regular	option	option	n/a
ESK 11	150	6"	n/a	regular	option	option	option
ESK 11	200	8"	n/a	regular	option	option	option
ESK 11	250	10"	n/a	regular	option	n/a	option
ESK 11	300	12"	n/a	regular	option	n/a	option
Type COMBI 01 - threaded inlet, flanged outlet							
COMBI 01	50	2"	regular	n/a	option	n/a	n/a
Type COMBI 11 - flanged							
COMBI 11	50	2"	regular	n/a	option	n/a	n/a
COMBI 11	80	3"	n/a	regular	option	n/a	n/a
COMBI 11	100	4"	n/a	regular	option	option	option
Type COMBI 11 - flanged, oval version							
COMBI 11	50.O	2"	n/a	regular	option	n/a	n/a

Elbow ball check valves installation method

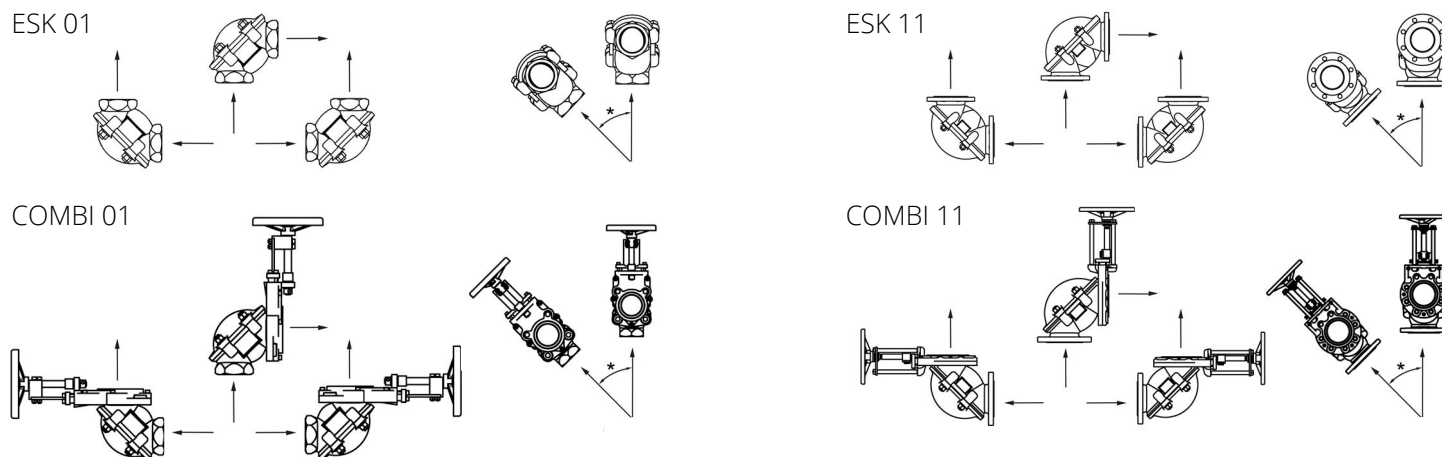

*Vertical deviation in the range:

0 – 10° – when used with solids as gravel and sand

0 – 45° – when used with drinking water

ELBOW BALL CHECK VALVES

COMBI ball check valves dimensions in accordance with the standard ANSI/ASME B16.1-2005 Class 125

COMBI 01

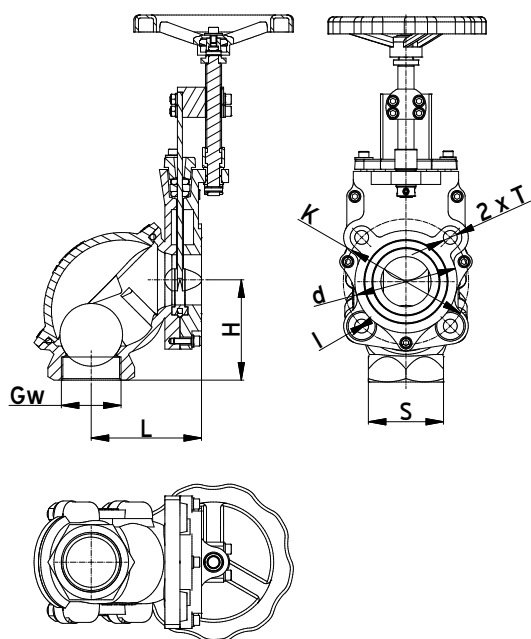

COMBI 11

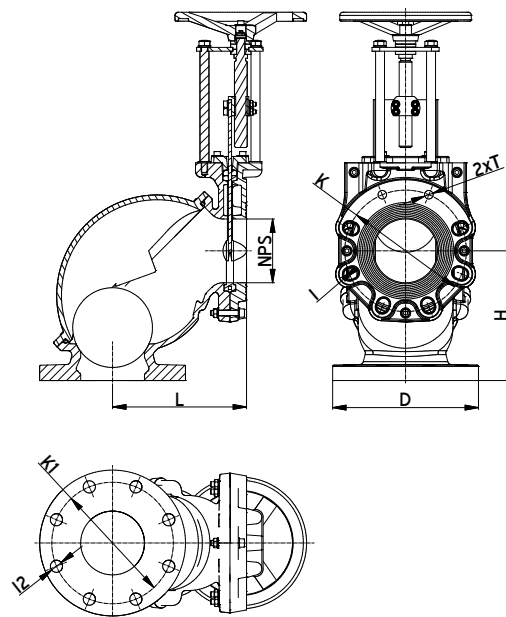

COMBI 11 oval

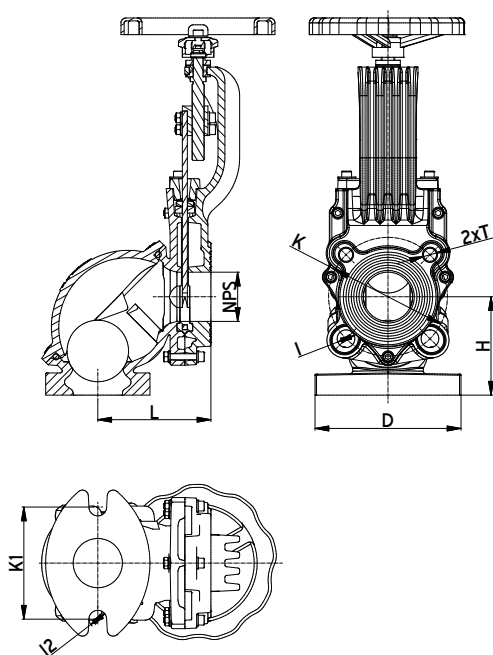

Type	DN	Size	L	H	D	K	K1	I	2 x T	I2	FK	Weight
												[lb]
							[inch]					
COMBI 01	50	2"	4 1/2"	3 15/16"	NPT 2"	4 3/4"	NPT 2"	3/4" x 2	2 x 5/8-11 UNC	NPT 2"	2.6	19
COMBI 11	50	2"	4 1/2"	3 3/4"	6 1/2"	4 3/4"	4 3/4"	3/4" x 2	2 x 5/8-11 UNC	3/4" x 4	2.6	29
COMBI 11	50.0*	2"	4 1/2"	3 3/4"	5 7/8"	4 3/4"	4 1/2"	3/4" x 2	2 x 5/8-11 UNC	3/4" x 4		22.3
COMBI 11	80	3"	7 1/16"	6 1/2"	7 1/2"	6"	6"	3/4" x 2	2 x 5/8-11 UNC	3/4" x 4		54
→ COMBI 11	100	4"	8 1/4"	8"	9"	7 1/2"	7 1/2"	3/4" x 6	2 x 5/8-11 UNC	3/4" x 8		74.3

*Oval version

FK – factor K within the recommended range of flow velocity through the valve from 2.3 fps to 8.2 fps