

RELIABILITY™

Provin

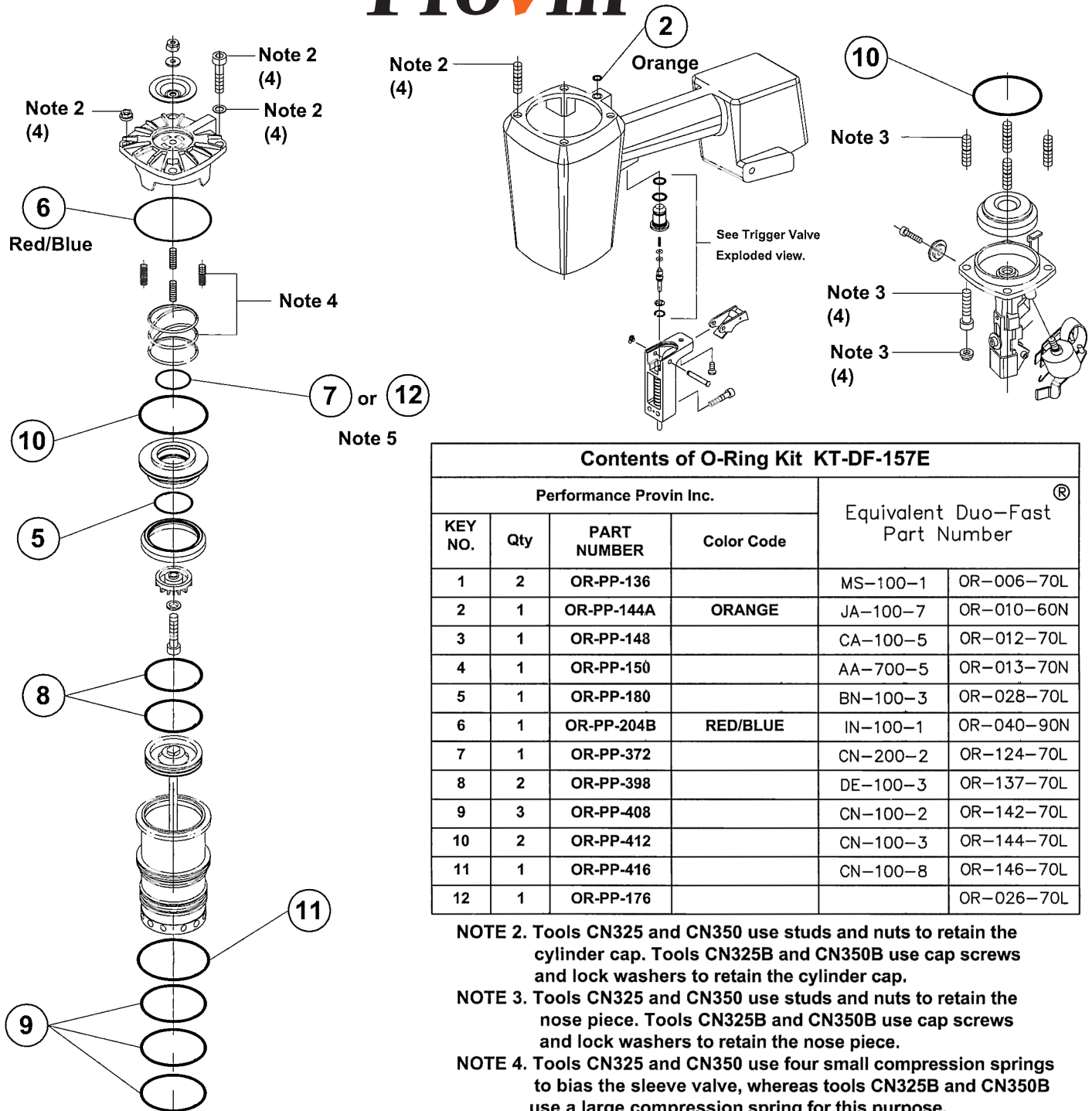

Contents of O-Ring Kit KT-DF-157E					
Performance Provin Inc.				Equivalent Duo-Fast® Part Number	
KEY NO.	Qty	PART NUMBER	Color Code		
1	2	OR-PP-136		MS-100-1	OR-006-70L
2	1	OR-PP-144A	ORANGE	JA-100-7	OR-010-60N
3	1	OR-PP-148		CA-100-5	OR-012-70L
4	1	OR-PP-150		AA-700-5	OR-013-70N
5	1	OR-PP-180		BN-100-3	OR-028-70L
6	1	OR-PP-204B	RED/BLUE	IN-100-1	OR-040-90N
7	1	OR-PP-372		CN-200-2	OR-124-70L
8	2	OR-PP-398		DE-100-3	OR-137-70L
9	3	OR-PP-408		CN-100-2	OR-142-70L
10	2	OR-PP-412		CN-100-3	OR-144-70L
11	1	OR-PP-416		CN-100-8	OR-146-70L
12	1	OR-PP-176			OR-026-70L

NOTE 2. Tools CN325 and CN350 use studs and nuts to retain the cylinder cap. Tools CN325B and CN350B use cap screws and lock washers to retain the cylinder cap.

NOTE 3. Tools CN325 and CN350 use studs and nuts to retain the nose piece. Tools CN325B and CN350B use cap screws and lock washers to retain the nose piece.

NOTE 4. Tools CN325 and CN350 use four small compression springs to bias the sleeve valve, whereas tools CN325B and CN350B use a large compression spring for this purpose.

NOTE 5. Tools CN325, CN350 and CN350B use O-Ring OR-PP-372 at the indicated location in the sleeve valve. Tool CN325B uses O-Ring OR-PP-176 at the same location. However, there may be some issue CN350B tools that use O-Ring OR-PP-176 rather than OR-PP-372.

*Generously grease all O-rings at time of assembly

Note: Read and understand the safety information printed on the reverse side before repairing any tools.
Nota: Lea y comprende la información de seguridad impresa al reverso antes de reparar cualquier herramienta.

8/23/2007

Exploded View and O-ring List for
DUO-FAST CN325, CN350, CN325B & CN350B

VL-DF-13

CAUTION**CAUTION****CAUTION**

ALWAYS WEAR SAFETY GLASSES WITH SIDE SHIELDS WHEN USING PNEUMATICALLY OPERATED FASTENER DRIVING TOOLS

NEVER POINT THE TOOL AT YOURSELF OR ANYONE ELSE

NEVER BYPASS OR REMOVE ANY SAFETY DEVICE

ALWAYS FOLLOW THE ORIGINAL MANUFACTURE'S SAFETY AND SERVICE INSTRUCTION

NEVER ATTEMPT TO SERVICE OR REPAIR A PNEUMATICALLY OPERATED TOOL WITH THE COMPRESSES AIR LINE CONNECTED TO THE TOOL

NEVER LEAVE A PNEUMATICALLY OPERATED TOOL UNATTENDED WITH THE COMPRESSES AIR LINE CONNECTED

ALWAYS FOLLOW THE ORIGINAL TOOLS MANUFACTURE'S DISASSEMBLY, ASSEMBLY, AND TOOL INSPECTION PROCEDURES

PRECAUTION**PRECAUTION****PRECAUTION**

SIEMPRE USE LENTES DE SEGURIDAD CON PROTECTORES LATERALES AL USAR HERRAMIENTAS DE IMPULSO CON SUJETADOR DE OPERACIÓN NEUMÁTICA

NUNCA APUNTE A SI MISMO O A OTRA PERSONA CON LA HERRAMIENTA

NUNCA EVITE O RETIRE ALGÚN DISPOSITIVO DE SEGURIDAD

SIEMPRE SIGA LAS INSTRUCCIONES DE SEGURIDAD Y SERVICIO DEL FABRICANTE ORIGINAL DE LA HERRAMIENTA

NUNCA INTENTE HACER MANTENIMIENTO O REPARAR UNA HERRAMIENTA DE OPERACIÓN NEUMÁTICA CON LA LINEA DE AIRE COMPRIMIDO CONECTADA A LA HERRAMIENTA

NUNCA DEJE SIN ATENCIÓN UNA HERRAMIENTA DE OPERACIÓN NEUMÁTICA CON LA LINEA DE AIRE COMPRIMIDO CONECTADA

SIEMPRE SIGA LOS PROCEDIMIENTOS DE DESMONTAJE, MONTAJE, E INSPECCIÓN DEL FABRICANTE ORIGINAL DE LA HERRAMIENTA

Trigger Valve Exploded View

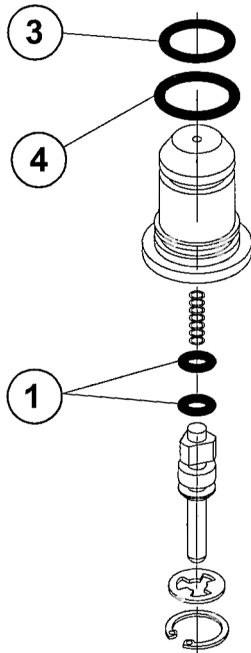

O-Ring Kit

KT-DF-157E

For use on the following tool models.
Kit contains all O-Rings in these tools.

DUO-FAST

CN325
CN325B
CN350
CN350B



7 12218 00118 1