

NOTES:

- ①④ ①② 1. SLOTTED REGULAR HEX HEAD SCREW
MADE TO ASME B18.6.3
- ①③ ★ 2. MATERIAL:
CARBON STEEL ZINC PLATED
OR YELLOW TRIVALENT COATED.
- 3. RoHS DIRECTIVE
COMPLIANCE REQUIRED.

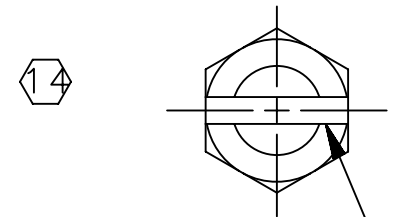

SLOT MAY BE
AT RANDOM TO
HEX FLATS

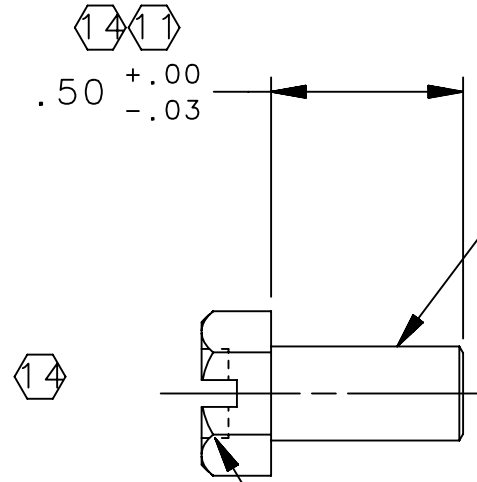

①④ ①①
.50 ^{+.00}/_{-.03}

①④ INDENTATION
OPTIONAL

★ 1/4-20 UNC-2A

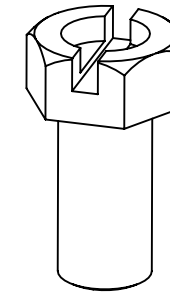

★ = MAJOR CHARACTERISTIC
★ = CRITICAL CHARACTERISTIC

MODIFIED NOTE 1: REMOVED DIMS. .50 WAS ".L". MODIFIED CALLOUT. REMOVED TABLE. MODIFIED TITLE NAME. 06/21		23878AA FIRKUS	ECN & NAME	2
MODIFIED NOTE 2 & TITLE NAME. 05/20		23652AA FIRKUS	MM/YY	
MODIFIED NOTE 1: B18.6.3 WAS B18.3.6 .371 ±.004 WAS .372 ±.007 .075/.064 WAS .075/.065 01/19		23385AA FIRKUS		
UPDATED TITLE BLOCK REMOVED ALL OLD REVS CHANGED DWG SIZE FROM A TO B DIM ".L" -.03/+.00 WAS +.00/+.03 06/18		23263AA JOAN		
NO.	DESCRIPTION			
NX PART/ASM REVISION 2				
DIMENSIONING & TOLERANCING PER ASME Y14.5-2009 DIMENSIONS ARE IN INCHES UNLESS OTHERWISE SPECIFIED DO NOT SCALE PRINT		MATERIAL: SEE NOTES DRAWN BY: GORSISKI DATE: 09/22/87		3RD ANGLE PROJECTION
DIMENSIONAL TOLERANCES UNLESS OTHERWISE SPECIFIED X.X ± 0.02 X.XX ± 0.01 X.XXX ± 0.005 ANGULAR ± 0.5° FRACTION ± 1/16		CH'KD BY: W McCORMICK 10/23/87 APP'D BY: F ANHOLD 10/23/87 REVISED APP'D BY: B. Blanke 5/28/21		STOCK NO. N/A SCALE: 2:1 SHEET: 1 of 1 DRAWING NO. 1468
NAME: SCREW, 1/4-20 SLTD HEX				DRAWING NO. 1468 DIST CODE: P I SIZE: B



CONFIDENTIAL AND PROPRIETARY
 Information disclosed on this document is considered proprietary and shall not be reproduced or disclosed in any manner without written consent of Emerson Electric Company