

GAMMA 202/CC GAMMA 242/CC

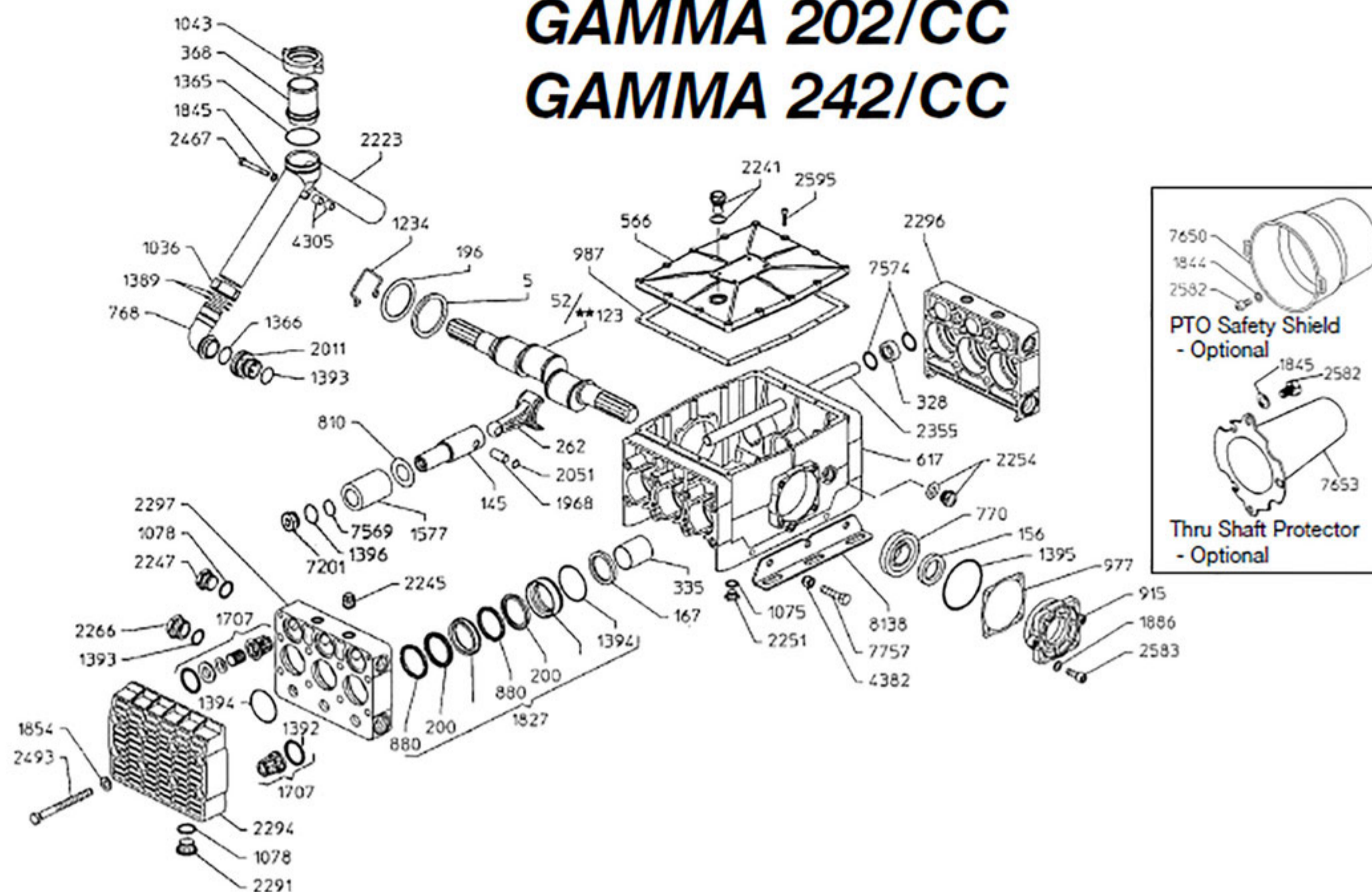

| Ref # | Part # | Description | Qty |
|--------|-----------|------------------------|-----|
| 5 | | Retainer Ring | 6 |
| 52 | | Crankshaft (GAMMA-202) | 1 |
| 123 ** | | Crankshaft (GAMMA-242) | 1 |
| 145 | | Plunger Rod | 6 |
| 156 | | Crankshaft Seal | 2 |
| 167 | U0007.24* | Crankcase Seal | 6 |
| 196 | | Spacer Ring | 6 |
| 200 | U0021.01* | High Pressure Seal | 12 |
| 262 | | Connecting Rod | 6 |
| 328 | U0113.10 | Tube Bushing | 2 |
| 335 | U0115.10* | Rod Guide | 6 |
| 368 | U0202.70* | Straight Barb | 1 |
| 566 | | Crankcase Cover | 1 |
| 617 | | Crankcase | 1 |
| 768 | U0229.02* | Inlet Elbow | 2 |
| 770 | U0248.01* | Crankshaft Bearing | 2 |
| 810 | U0301.45* | Slinger Ring | 6 |
| 880 | U0307.01* | Support Ring | 12 |
| 915 | | Bearing Cover | 2 |
| 977 | U0602.05 | Gasket | 2 |
| 987 | U0602.35 | Cover Gasket | 1 |
| 1036 | U0604.13 | Brass Nut | 2 |
| 1043 | U0604.31 | Barb Nut | 1 |
| 1075 | U0605.43* | Plug Gasket | 1 |
| 1078 | U0605.48* | Plug Gasket | 6 |
| 1234 | | Retainer Clip | 6 |
| 1365 | U1101.01 | O-Ring | 1 |
| 1366 | U1101.02 | O-Ring | 2 |
| 1389 | U1101.41 | O-Ring | 4 |
| 1392 | U1101.45 | O-Ring | 12 |
| 1393 | U1101.46 | O-Ring | 4 |
| 1394 | U1101.47 | O-Ring | 12 |

*Not sold on our website, but available to order by phone or at a CCI store.

** Parts for GAMMA-242 Only

| Ref # | Part # | Description | Qty |
|-------|-----------|-------------------------------------|-----|
| 1395 | U1101.48 | O-Ring | 2 |
| 1396 | | O-Ring | 6 |
| 1577 | U1205.17* | Plunger | 6 |
| 1707 | U6006.06* | Valve Assembly | 12 |
| 1827 | U6030.00 | Seal Stack Assembly | 6 |
| 1844 | U1403.09 | Washer (For optional PTO Shield) | 2 |
| 1845 | U1403.10 | Washer | 2 |
| 1854 | | Washer | 16 |
| 1886 | | Washer | 8 |
| 1968 | | Rod Pin | 6 |
| 2011 | U1504.02* | Inlet Fitting | 2 |
| 2051 | U1506.15* | Snap Ring | 12 |
| 2223 | | Inlet Y-Fitting | 1 |
| 2241 | U1603.B2* | Vented Oil Cap | 1 |
| 2245 | U1603.16* | Manifold Plug | 4 |
| 2247 | U1603.74* | Manifold Plug | 2 |
| 2251 | U1603.02 | Oil Drain Plug | 1 |
| 2254 | U1603.06* | Oil Sight Glass | 1 |
| 2266 | U1603.30* | Manifold Plug | 2 |
| 2291 | U1603.A3* | Manifold Plug | 6 |
| 2294 | U1604.87* | Discharge Manifold | 2 |
| 2296 | U1604.89* | Inlet Manifold, Right | 1 |
| 2297 | U1604.90 | Inlet Manifold, Left | 1 |
| 2355 | | Balancing Tube | 1 |
| 2467 | U1804.10* | Bolt | 1 |
| 2493 | | Head Bolt | 16 |
| 2582 | U1805.04* | Bolt (For optional Shaft Protector) | 4 |
| 2583 | | Bolt | 8 |
| 2595 | | Bolt | 14 |
| 4305 | U0302.45* | Spacer | 2 |
| 4382 | | Nut | 4 |
| 7201 | | Plunger Nut | 6 |
| 7569 | U1101.49 | O-Ring | 6 |
| 7574 | U1101.B1 | O-Ring | 4 |
| 7650 | U1219.02* | PTO Safety Shield (Optional) | 1 |
| 7653 | U1219.15 | Thru-Shaft Protector (Optional) | 1 |
| 7757 | | Bolt | 4 |
| 8138 | U1202.57* | Rail | 2 |